

REVISIONS			
REV.	DESCRIPTION	DATE	APPROVED

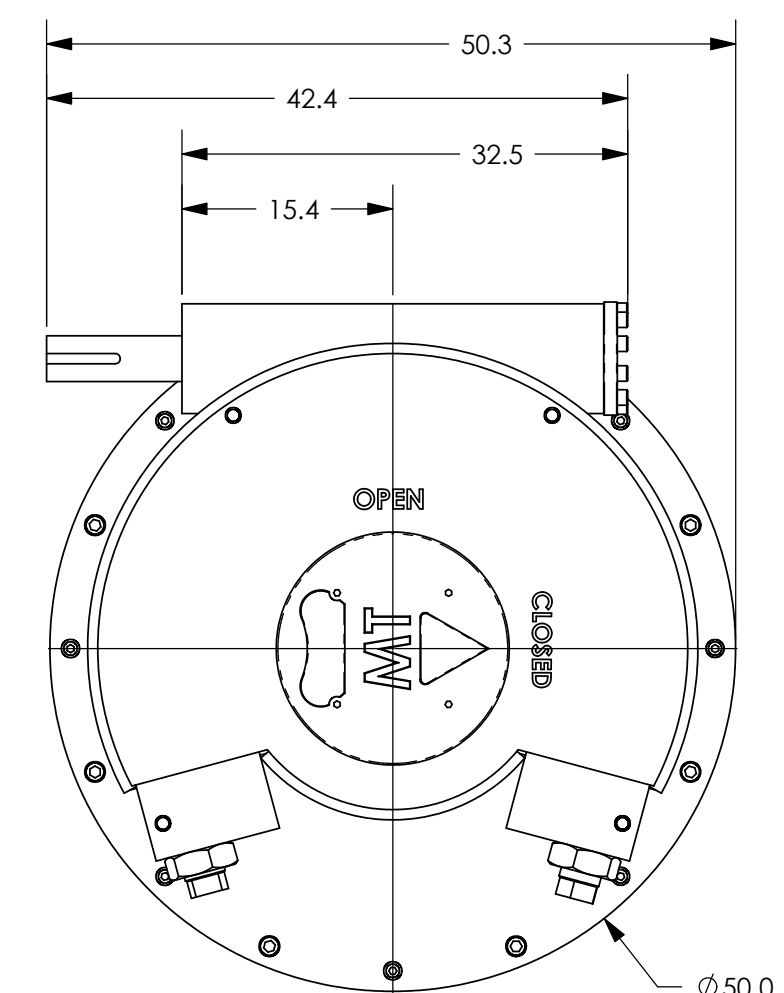
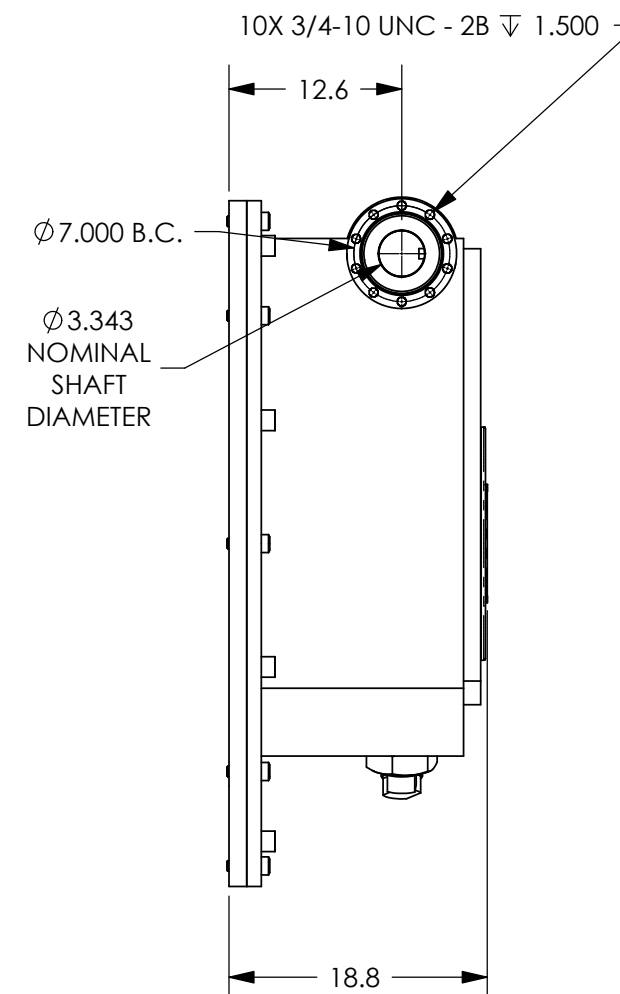
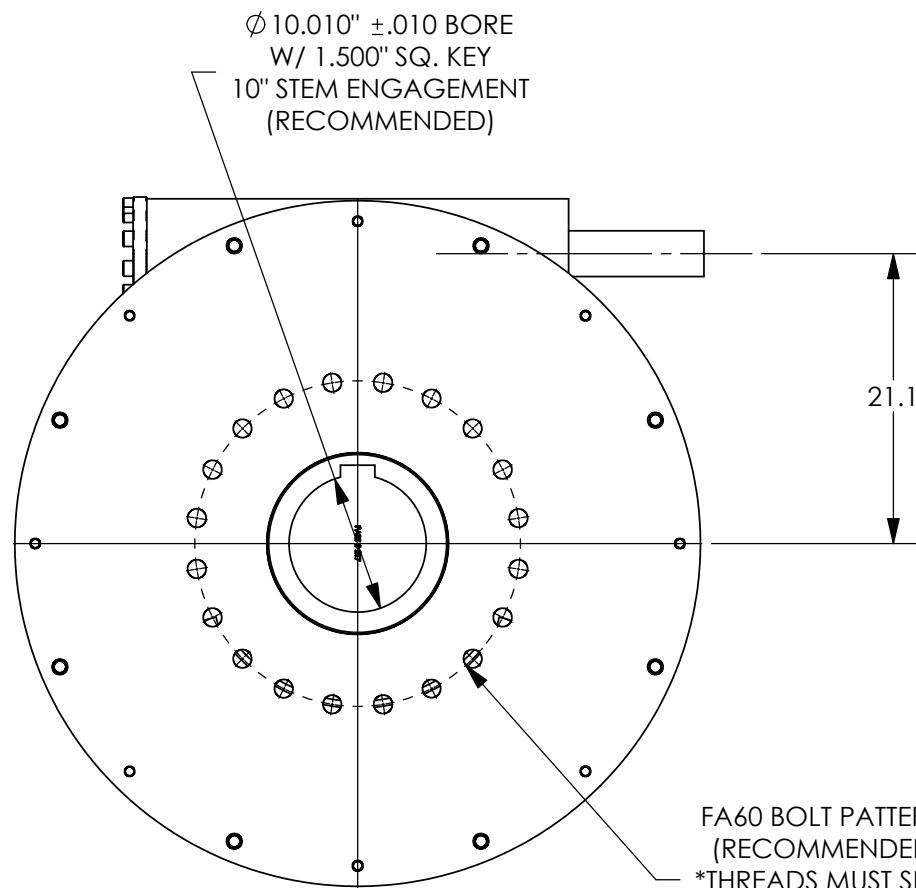

FA60 BOLT PATTERN
 (RECOMMENDED)
 *THREADS MUST SEAL
 AT ASSEMBLY TO
 VALVE

RATIO: 30.75 : 1
 MAX. BORE & KEY: $\phi 10''$, WITH 2 1/2" X 2" KEY
 MAX. STEM ENGAGEMENT: 14 3/4"
 BOLT PATTERN TO SUIT
 (OTHER BASE PLATES AVAILABLE)
 WEIGHT: APPROX. 3600 LBS.

UNLESS OTHERWISE SPECIFIED:		NAME	DATE
DIMENSIONS ARE IN INCHES		DRAWN	JRM 03.18.05
TOLERANCES:		CHECKED	
FRACTIONAL $\pm 1/32$		ENG APPR.	
ANGULAR: MACH $\pm 1/2$		MFG APPR.	
BEND $\pm 1/2$		Q.A.	
TWO PLACE DECIMAL $\pm .02$		COMMENTS:	
THREE PLACE DECIMAL $\pm .005$			
MATERIAL:			
N/A			
FINISH:			
N/A			
DO NOT SCALE DRAWING			

PROPRIETARY AND CONFIDENTIAL
 THE INFORMATION CONTAINED IN THIS
 DRAWING IS THE SOLE PROPERTY OF
 MAX TORQUE. ANY REPRODUCTION IN
 PART OR AS A WHOLE WITHOUT THE
 WRITTEN PERMISSION OF
 MAX TORQUE IS PROHIBITED.

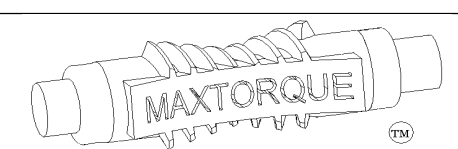

TITLE: **MW3**
 STANDARD UNIT (LHP)

SIZE **B** DWG. NO. **300052**

SCALE: 1:14 WEIGHT: 3600 lbs SHEET 1 OF 1

Friday, March 18, 2005 4:09:10 PM